



## Crosby® Real Life Solutions

*Same Dependability and Durability with a new finish . . .*

- Sizes: 3/8" through 3/4".
- Capacities: 1 through 4-3/4 metric tonnes.
- Forged - Quenched and Tempered, with alloy pins.
- Working Load Limit permanently shown on every shackle.
- Flat black baked on powder coat finish.
- Fatigue Rated.
- Industry leading 6 to 1 design factor.
- Screw pin anchor shackles meet the performance requirement of Federal Specification RR-C-271D Type IV A, Grade a, Class 2, except for those provisions required of the contractor.
- Meets the performance requirements of EN13889:2003.
- Crosby products meet or exceed all requirements of ASME B30.26 including identification, ductility, design factor, proof load and temperature requirements. Importantly, Crosby products meet other critical performance requirements including fatigue life, impact properties and material traceability, not addressed by ASME B30.26.



**Fatigue Rated**

**MAXTOUGH**

**Load Rated**

### Crosby® Real Life Solutions

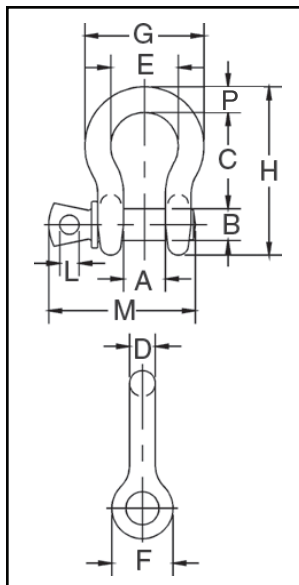

Nominal Size (in.)	Working Load Limit (t)*	Stock No. S-209T	Weight Each (lbs.)	Dimensions (in.)												Tolerance +/-	
				A	B	C	D	E	F	G	H	L	M	P	C	A	
3/8	1	1018706	.31	.66	.44	1.44	.38	1.03	.91	1.78	2.49	.25	2.02	.38	.13	.06	
7/16	1-1/2	1018724	.38	.75	.50	1.69	.44	1.16	1.06	2.03	2.91	.31	2.37	.44	.13	.06	
1/2	2	1018742	.72	.81	.63	1.88	.50	1.31	1.19	2.31	3.28	.38	2.69	.50	.13	.06	
5/8	3-1/4	1018760	1.37	1.06	.75	2.38	.63	1.69	1.50	2.94	4.19	.44	3.34	.69	.13	.06	
3/4	4-3/4	1018778	2.35	1.25	.88	2.81	.75	2.00	1.81	3.50	4.97	.50	3.97	.81	.25	.06	

Nominal Size (in.)	Working Load Limit (t)*	Stock No. S-209T	Weight Each (kg)	Dimensions (mm)												Tolerance +/-	
				A	B	C	D	E	F	G	H	L	M	P	C	A	
3/8	1	1018706	.14	16.8	11.2	36.6	9.65	26.2	23.1	45.2	63.0	6.35	51.5	9.65	3.30	1.50	
7/16	1-1/2	1018724	.17	19.1	12.7	42.9	11.2	29.5	26.9	51.5	74.0	7.85	60.5	11.2	3.30	1.50	
1/2	2	1018742	.33	20.6	16.0	47.8	12.7	33.3	30.2	58.5	83.5	9.65	68.5	12.7	3.30	1.50	
5/8	3-1/4	1018760	.62	26.9	19.1	60.5	16.0	42.9	38.1	74.5	106	11.2	85.0	17.5	6.35	1.50	
3/4	4-3/4	1018778	1.07	31.8	22.4	71.5	19.1	51.0	46.0	89.0	126	12.7	101	20.6	6.35	1.50	

\*NOTE: Maximum Proof Load is 2.0 times the Working Load Limit. Minimum Ultimate Strength is 6 times the Working Load Limit. For Working Load Limit reduction due to side loading applications, see the Crosby General Catalog.



Crosby U.S.A.  
P.O. Box 3128  
Tulsa, OK 74101  
U.S.A.  
Sales Office: (918) 834-4611  
FAX: (918) 832-0940  
crosbygroup@thecrosbygroup.com

Crosby Canada  
145 Heart Lake Road  
Brampton, Ontario, L6W 3K3  
Canada  
Sales Office: (905) 451-9261  
FAX (877) 260-5106  
sales@crosby.ca

Crosby Europe  
Industriepark Zone B nr 26  
B-2220 Heist-op-den-Berg  
Belgium  
Sales Office: 32-15-757125  
FAX : 32-15-753764  
sales@crosbyeurope.com